

MF Co., Ltd. has concentrated single-mindedly on manufacturing and selling temporary protection products in Japan for more than 4 decades. We would like to introduce a traditional Japanese culture "YOJO" to the world. You must try to experience our culture this time!



Manufacturing company

 **MF CO.,LTD.**
<http://en.mf21.co.jp>



Distributor

Interra USA, Inc.
<https://shop.interra-usa.com>



HERO BOOK

HERO Protection Non-slip waterproof Sheet

Supreme multifunctional protection sheets

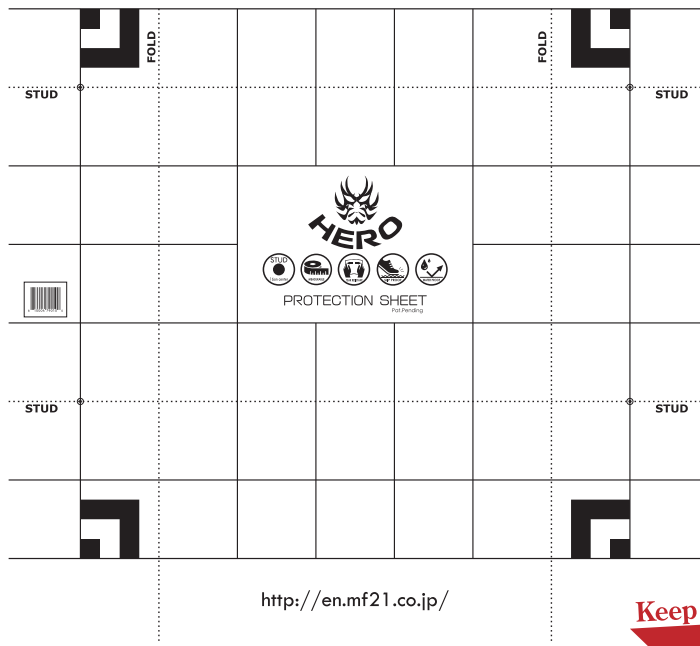

<http://en.mf21.co.jp/>



Keep construction sites safe with wide range functionality!

Features

- A special film can prevent slipping on the sheet.
- A waterproof effect is obtained by laminating the film.
- The tapes are hardly released due to the use of flatfilm at both sides of the sheet.
- The grid lines can be used as a scale to improve work efficiency.

Material

Special film + Core base paper (100% recycled paper)

Use

Protection sheet for floors

How to use

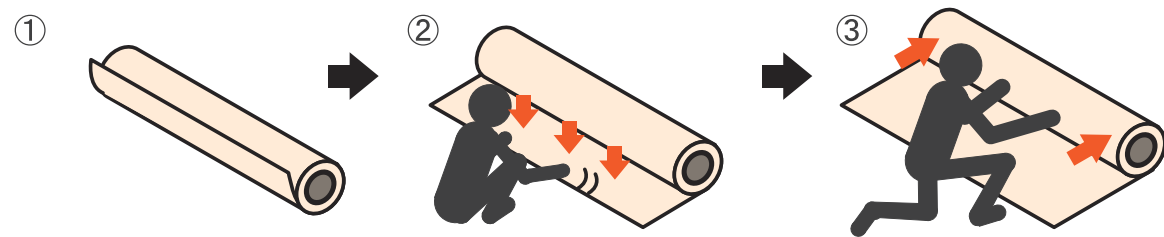

Product name	Main purpose	Thickness (inches)	Width (inches)	Length (feets-inches)	Weight (lbs/roll)	Quantity per case (roll)	Shipment lot (case)
HERO Protection Non-slip waterproof Sheet	Floor protection	1/32"	38"	98' 5"	13.2	1	1

1. Tear Resistant!

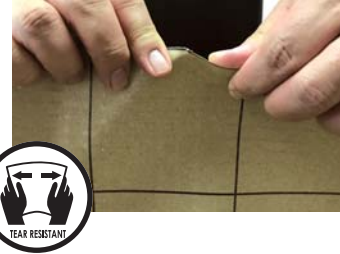

2. Slip Resistant!



3. Resistant to Water and Stain



4. Use the Guide to Take Measurements



HERO Protection Cushion waterproof Sheet

Supreme multifunctional protection sheets

Features

- Embossing processes provide cushioning and non-slip effect.
- A waterproof effect is obtained by laminating the film.
- The tapes are hardly released due to the use of flatfilm at both sides of the sheet.
- The grid lines can be used as a scale to improve work efficiency.

Material

Core base paper (100% recycled paper)

Use

Protection sheet for floors

How to use

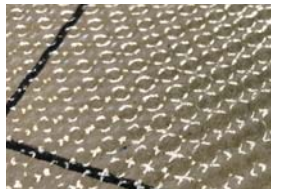
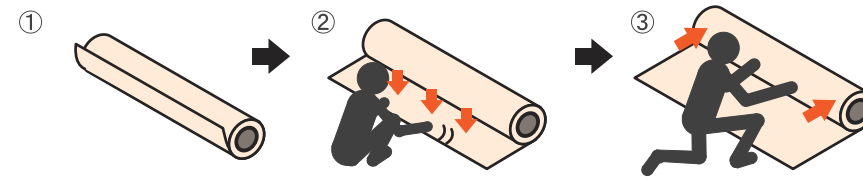

Product name	Main purpose	Thickness (inches)	Width (inches)	Length (feets-inches)	Weight (lbs/roll)	Quantity per case (roll)	Shipment lot (case)
HERO Protection Cushion waterproof Sheet	Floor protection	1/32"	38"	98' 5"	13.2	1	1

HERO Protection Board

Supreme multifunctional protection sheets

Features

- Embossing processes prevent warpage when spreading the board.
- Embossing processes can provide cushioning and non-slip effect.
- The grid lines can be used as a scale to improve work efficiency.

Material

Paper tube base paper

Use

Protection sheet for floors

How to use

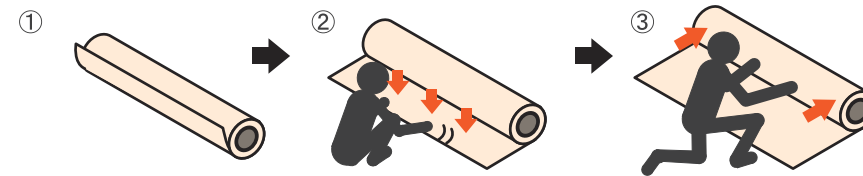

Product name	Main purpose	Thickness (inches)	Width (inches)	Length (feets-inches)	Weight (lbs/roll)	Quantity per case (roll)	Shipment lot (case)
HERO Protection Board	Floor protection	1/32"	38"	98' 5"	13.2	1	1

Temp-Protection Board (Thin)

Protection board with measurable scales

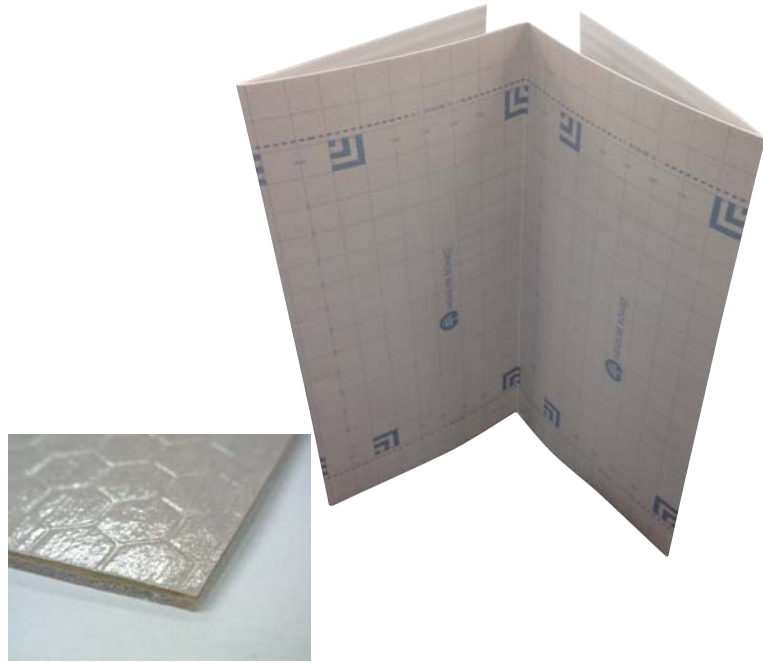

Features

- The grid lines make it convenient for cutting.
- Various lines and scales will assist in laying out your floor protection.
- Foldable into four compact sections.

Material

Surface: Polyethylene film and Core paper board
Back: Polyethylene foam

Use

For protection of floors and corridors

How to use

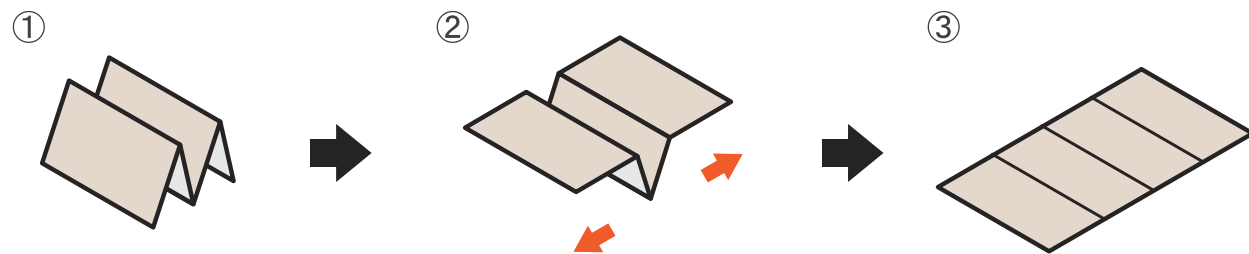

Product name	Main purpose	Thickness (inches)	Width (inches)	Length (feet)	Weight (lbs/sheet)	Quantity per case (sheets)	Shipment lot (sheets)
Temp-Protection Board (Thin)	Floor protection	1/8"	36"	6'	2.3	20	20

Temp-Protection Roll (Water-Resistant Paper)

The standard for protecting floors

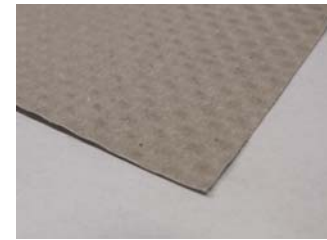

Features

- For protecting the surfaces of floors, stairs or corridors.
- Emboss-processing for preventing slip.

Material

Polyethylene film, 100% recycled paper and polyethylene coating

Use

For protection of indoor floors, stairs and corridors
Floor protection of polling place, etc.

How to use

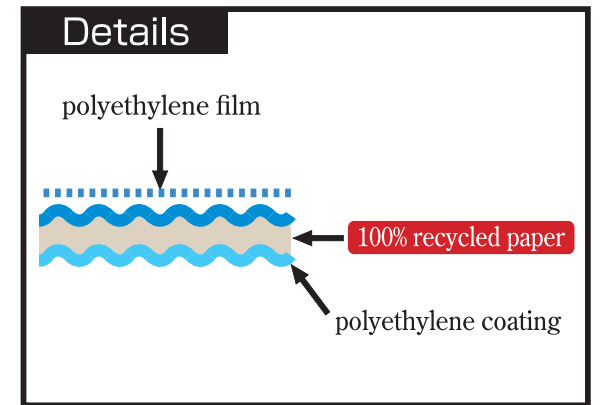
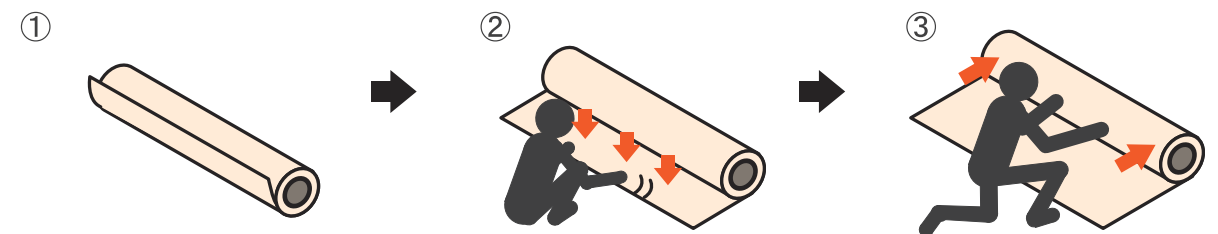

Product name	Main purpose	Thickness (inches)	Width (inches)	Length (feet)	Weight (lbs/roll)	Quantity per case (rolls)	Shipment lot (roll)
Temp-Protection Roll (Water-Resistant Paper)	Floor protection	1/80"	40"	164'	15.4	2	2

Temp-Protection Board (Tread & Riser)

Reusable due to laminating process

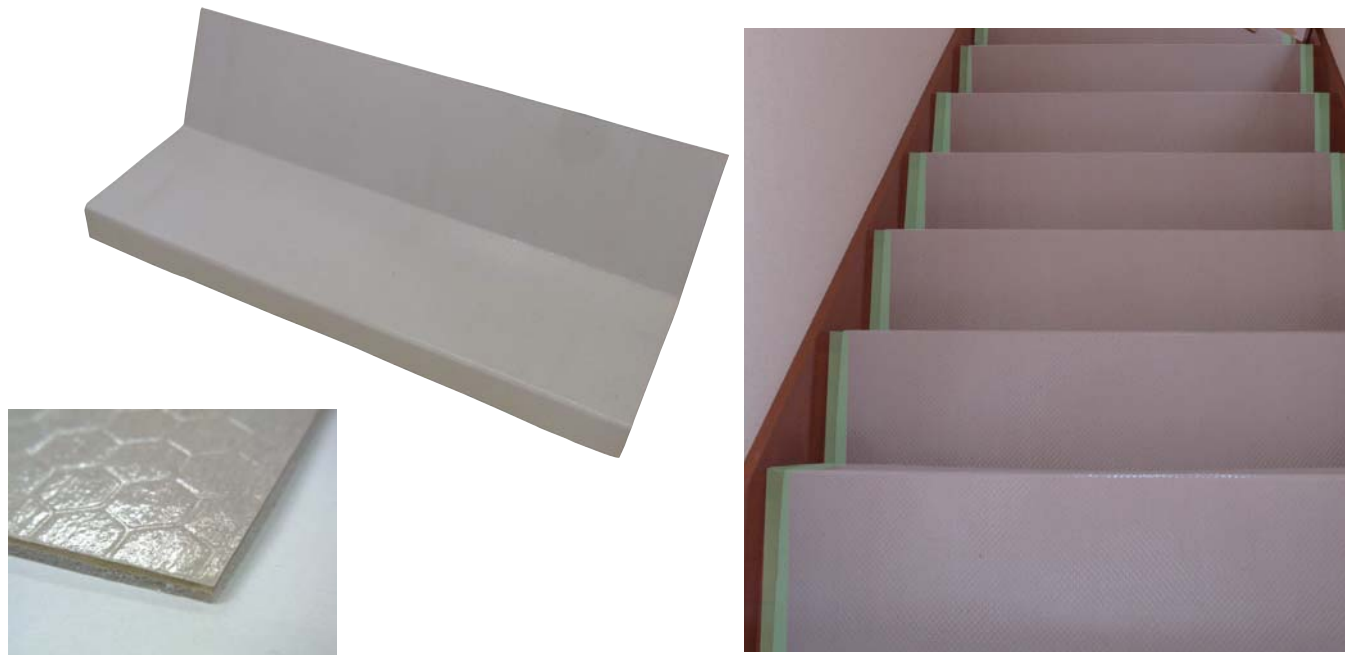

Features

- Excellent shock absorption due to cushion materials in the reverse side.
- Superior waterproof and repetitively usable due to lamination processing.

Material

Polyethylene film, paper board and polyethylene foam

Use

For protection of stairs

How to use

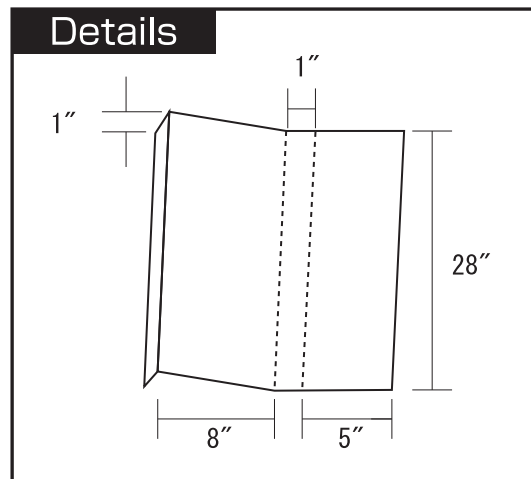
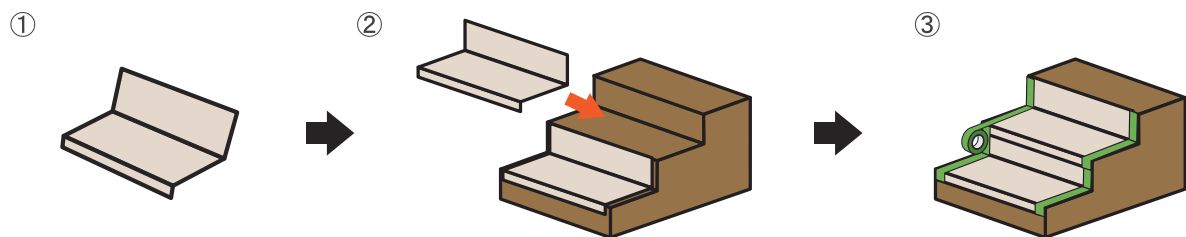

Product name	Main purpose	Thickness (inches)	Width (inches)	Step size (inches)	Riser size (inches)	Weight (lbs/sheet)	Quantity per case (sheets)	Shipment lot (case)
Temp-Protection Board (Tread & Riser)	Steps protection	1/8"	28"	8"- 9"	5"- 6"	0.5	16	1

Temp-Protection Board (Soft / Hard)

Highly recommended for remodeling or maintenance

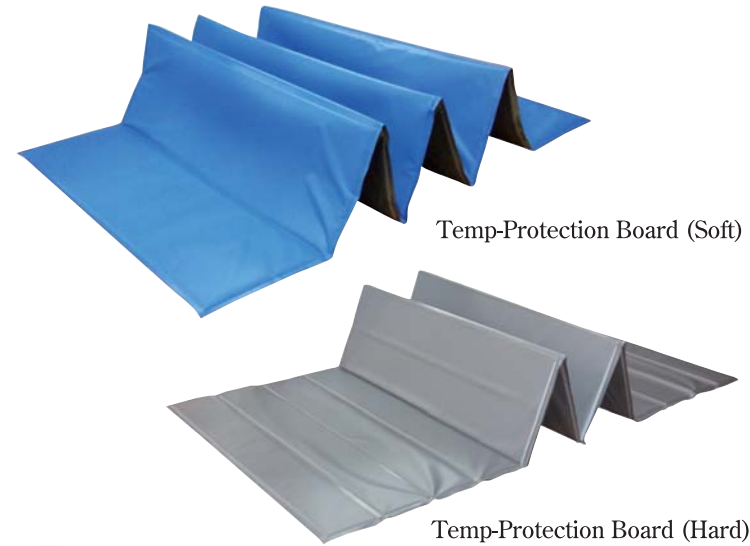

Features

- Easy to fold up and little space to store.
- Suitable for any spots without cutting.
- Durable, reusable and shock-resistant.
- Adaptable to narrow spots such as bathrooms due to using polyethylene foam materials.

Material

Temp-Protection Board (Soft):
Polyethylene foam (PVC tarpaulin on both sides)
Temp-Protection Board (Hard):
Plastic veneer (PVC tarpaulin on both sides)
*PVC=Poly Vinyl Chloride

Use

For partial protection and material storing sites in remodeling or maintenance.

How to use

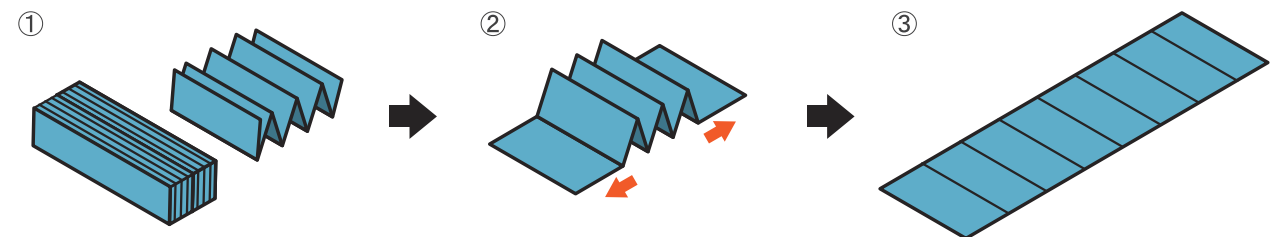

Product name	Main purpose	Thickness (inches)	Width (inches)	Length (feets)	Weight (lbs/sheet)	Quantity per case (sheets)	Shipment lot (case)
Temp-Protection Board (Soft)	Floor protection (partial)	3/16"	27"	6'	2.6	4	1
Temp-Protection Board (Hard)	Floor protection (partial)	3/16"	27"	6'	4.9	5	1



Sekisui Fit Light Tape No. 738

Environment-friendly adhesive tape for temporary protection materials

Features

- Reducing 10% of CO2 emission upon incineration (compared to the manufacturer's products)
- Recycled PET fibers are used to strengthen the tape.
- Adhering to polyethylene or polypropylene laminated papers and capable of adhering tapes overlaid each other.
- Possible to write on with an oil based pen.
- Low-residue due to special manufacturing process.

Material

Recycled PET

Use

For protection materials used in moving and construction work.

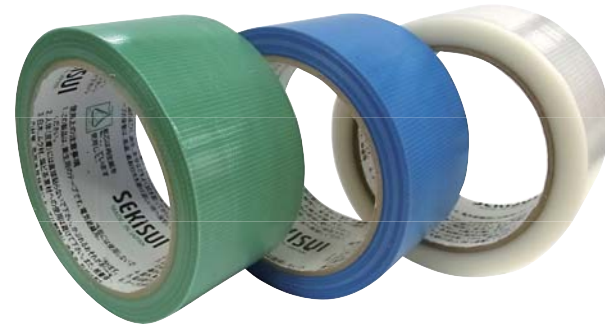

Product name	Main purpose	Thickness (inches)	Width (inches)	Length (feet)	Weight (lbs/tape)	Color	Quantity per case	shipment lot (case)
Sekisui Fit Light Tape No. 738	Fixed protective materials	0.004"	2"	82'	0.35	Green	30	1
		0.004"	2"	82'	0.35	Blue	30	1
		0.004"	2"	82'	0.35	Clear	30	1

Premium Low-Residue Tape

Strong adhesive tape for temporary protection materials

Features

- Easy to tear off by hand.
- Superior in wet or moist areas
- The synthetic resin makes it light weight and strong.

Material

Polyethylene cloth

Use

For temporary fixing for protection materials, etc.

How to use

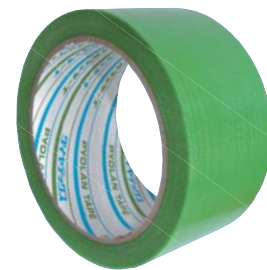
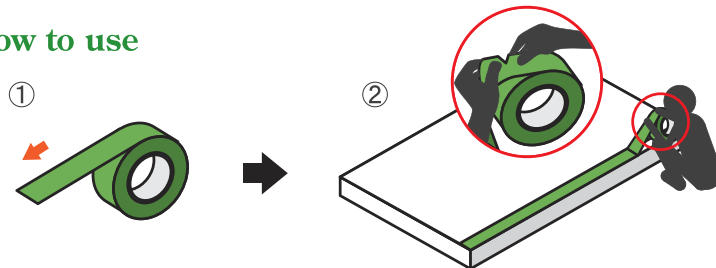

Product name	Main purpose	Thickness (inches)	Width (inches)	Length (feet)	Weight (lbs/tape)	Color	Quantity per case	shipment lot (case)
Premium Low-Residue Tape	Fixed protective materials	0.006"	2"	82'	0.35	Green	30	1
		0.006"	1.5"	82'	0.46	Green	36	1

Standard Low-Residue Tape

Earth-friendly adhesive tape

Features

- Fix protection sheets tightly and leave almost no residue.
- Easy and quick to tear off by hand.

Material

Special-processed polyolefin base material and acrylic adhesive material

Use

For temporary fixing of protection materials or for masking

How to use

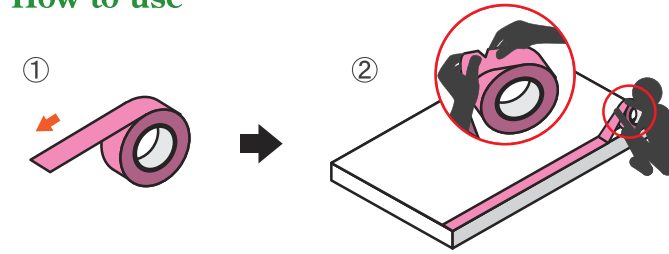

Product name	Main purpose	Thickness (inches)	Width (inches)	Length (feet)	Weight (lbs/tape)	Color	Quantity per case	Shipment lot (case)
Standard Low-Residue Tape	Fixed protective materials	0.005"	2"	82'	0.39	Pink	30	1

Pretaped Plastic Film Drop Cloth

The standard for protection

Features

- Use for either interior or exterior applications.
- The surface of walls or windows can be covered and bonded with a tape on one end side.
- Compact and little space to store.
- Excellent water and moisture resistance.

Material

Polyethylene and gummed fabric tape

Use

For partitions upon corting work and simple work in anywhere around house and inside of house.

How to use

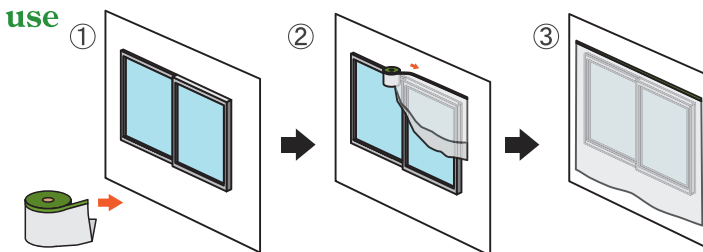

Product name	Main purpose	Thickness (inches)	Width (inches)	Length (feet)	Weight (lbs/roll)	Color	Quantity per case	Shipment lot (case)
Pretaped Plastic Film Drop Cloth	Masking	0.0004"	83"	82'	1.1	Young leaf	30	1

Non-Slip Moving Blankets

Reusable non-slip mats

Features

- Hard to slide due to non-slip processing on the back.
- Polyester fiber materials is durable enough to use repeatedly.
- Embroidery is available.

Material

Front: Polyester Back: Vinyl chloride

Use

For protection of floors and corridors, etc. during the worktime at sites or to put a tool box

How to use

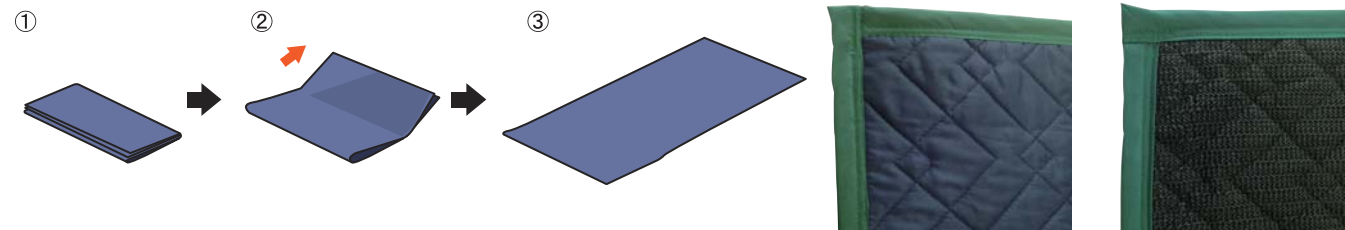

Product name	Main purpose	Thickness (inches)	Width (inches)	Length (feet)	Weight (lbs/sheet)	Quantity per case (sheets)	Shipment lot (case)
Non-Slip Moving Blankets	Floor protection (partial)	5/24"	35"	6'	2.6	10	1

Corner Guard

Foam-type, L-shaped protection materials

Features

- Unique shape is optimal.
- Easy to cut to the size you like.
- Tapered edge make it easy to install with tapes.

Material

Polyethylene foam

Use

For the corner protection of such spots as external corners, opening frames, columns, sashes, and around elevator.

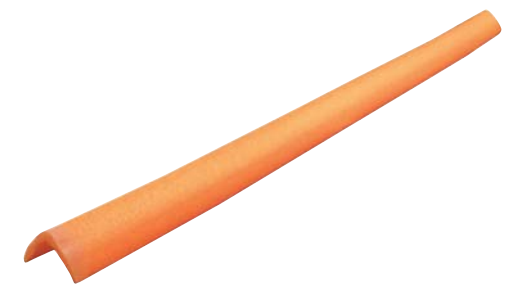

How to use

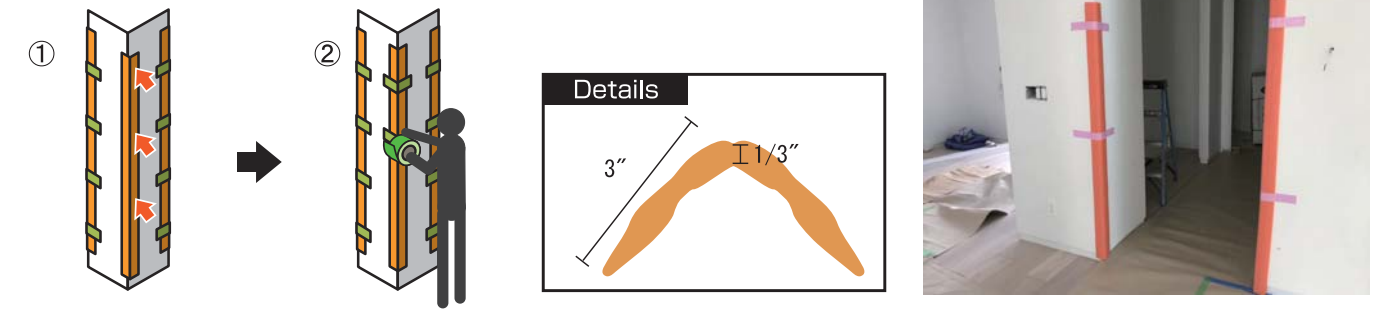

Product name	Main purpose	Thickness (inches)	Width (inches)	Length (feet)	Weight (lbs/piece)	Quantity per case	Shipment lot (case)
Corner Guard	Protection of external corners	1/3"	3" x 3"	6'	0.23	70	1

Door Jamb Guard

Protective covers adaptable to various shapes without adhesives

Features

- Due to flexibility it is hard to break when things hit or surface is scratched.
- Tapeless for installation.
- Easy to cut to use for handrails, copings and single pipe scaffoldings.

Material

Polyethylene foam

Use

For protection of pillars, opening frames, single pipe scaffoldings, front door knobs, stair copings, balcony railings, etc.

How to use

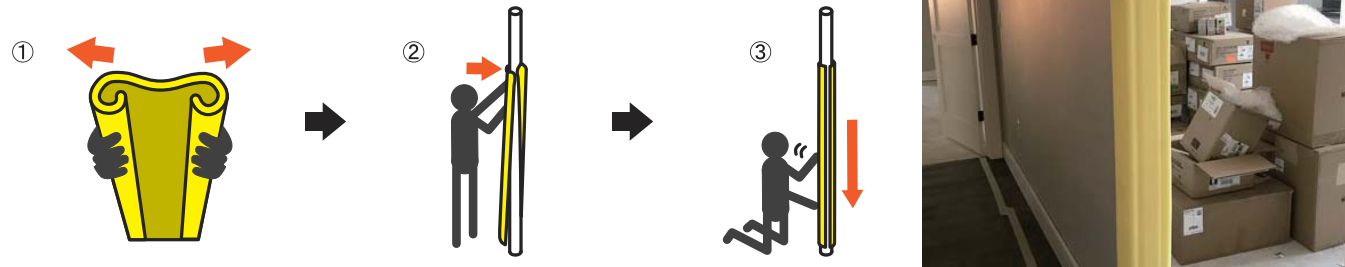

Product name	Main purpose	Thickness (inches)	Effective width (inches)	Length (feet)	Weight (lbs/piece)	Color	Quantity per case	shipment lot (case)
Door Jamb Guard	Protection of flames, pillars	7/24"	Up to 9"	6'	0.3	Yellow	40	1
Door Jamb Guard 3ft type	Protection of flames, pillars	7/24"	Up to 9"	3'	0.15	Yellow	30	1

Flexible Wall Guard

Curved surface and corner protection materials

Features

- Both surface and corner can be protected integrally.
- Use as a mat under a stepladder or a tool box.
- Easy to cut to the size you like.

Material

Polyethylene foam

Use

For the corner protection of such spots as telephone pole, external corners, opening frames, columns, sashes, and around elevator.



How to use

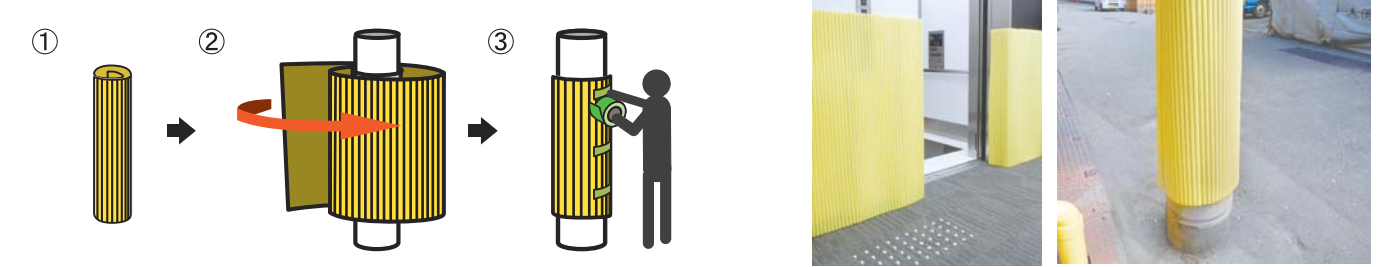

Product name	Main purpose	Thickness (inches)	Width (inches)	Length (feet)	Weight (lbs/piece)	Quantity per case	Shipment lot (case)
Flexible Wall Guard	Protection of external corners	1/3"	3" x 3"	6'	0.23	70	1