

Model No. (Coating, Suffix No.)

KXH3193-CR-C

KXH3193-BN-C

KXH3193-BLK -C

KXH3193-PB-C

KXH3193-BB-C



Single-Handle Lavatory Faucet

Description

- 3/8 Compression fittings
- Strong metal construction with excellent outer coating
- Five different color coatings available identified by alphabets such as CR=Chrome, BN=Brushed Nickel, BLK=Black, PB=Polished Brass, BB=Brushed Brass
- Includes a Click Waste identified by suffix -C
- Available an Escutcheon (4") additionally for three-hole wash basin

Operation

- Easy control of between hot and cold water and Open Close operation by one lever handle

Water Flow Rate

- Maximum Flow Rate is 1.2gpm (4.5L/min) at 60psi

Cartridge

- Contain durable ceramic disc for smooth and comfortable operation

Standards

- Third party certified to ASME A112.18.1/CSA B125.1, NSF 61 ($Q \leq 1$), NSF372, Water Sense and CEC
- California Proposition 65 Include lead (Pb) in the waste drain. For more information go to www.P65Warnings.ca.gov

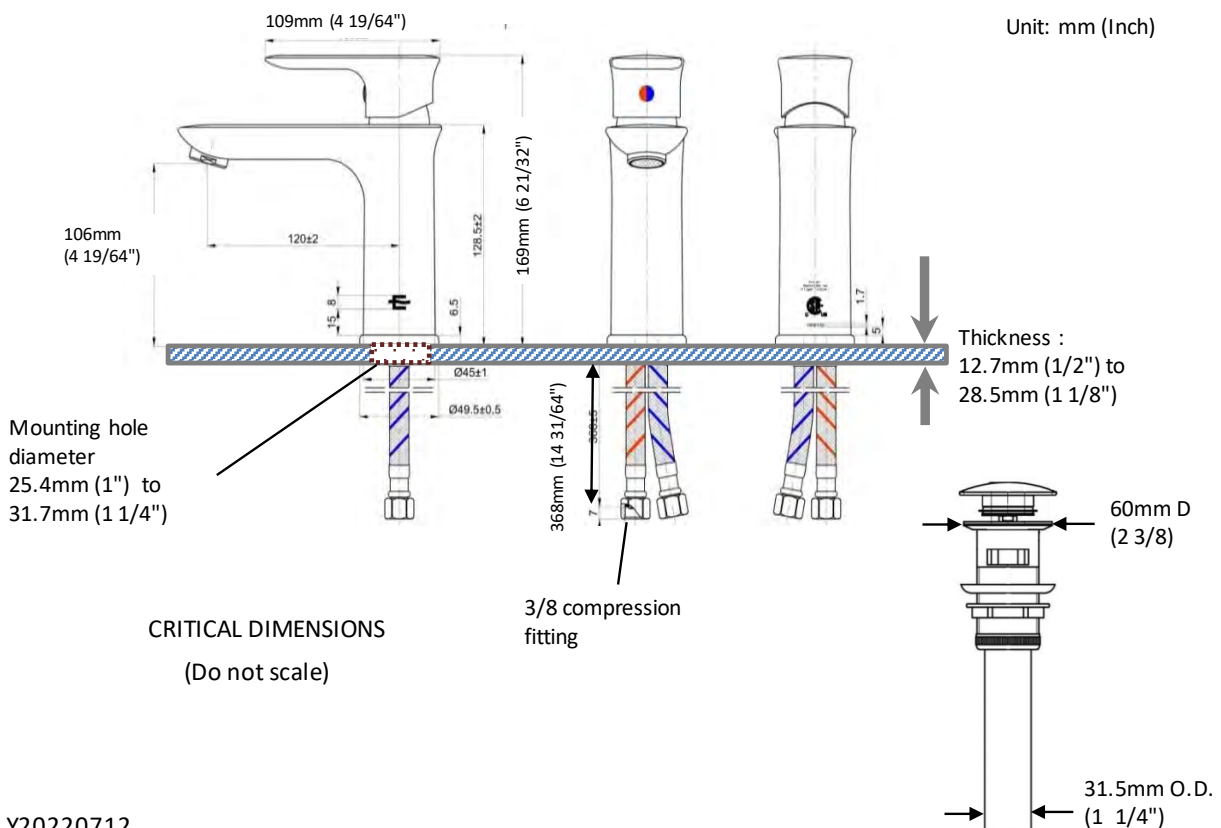

Model No. (Coating, Suffix No.)

KXH3203-CR-190-C

KXH3203-BN-190-C

KXH3203-BLK-190-C

KXH3203-PB-190-C

KXH3203-BB-190-C



Description

- 3/8 Compression fittings
- Strong metal construction with excellent outer coating
- Five different color coatings available identified by alphabets such as CR=Chrome, BN=Brushed Nickel, BLK=Black, PB=Polished Brass, BB=Brushed Brass
- Includes a Click Waste identified by suffix -C
- Available an Escutcheon (4") additionally for three-hole wash basin

Single-Handle Lavatory Faucet

Operation

- Easy control of between hot and cold water and Open Close operation by one lever handle

Water Flow Rate

- Maximum Flow Rate is 1.2gpm (4.5L/min) at 60psi

Cartridge

- Contain durable ceramic disc for smooth and comfortable operation

Standards

- Third party certified to ASME A112.18.1/CSA B125.1, NSF 61 (Q_s1), NSF372, Water Sense and CEC
- California Proposition 65 Include lead (Pb) in the waste drain. For more information go to www.P65Warnings.ca.gov

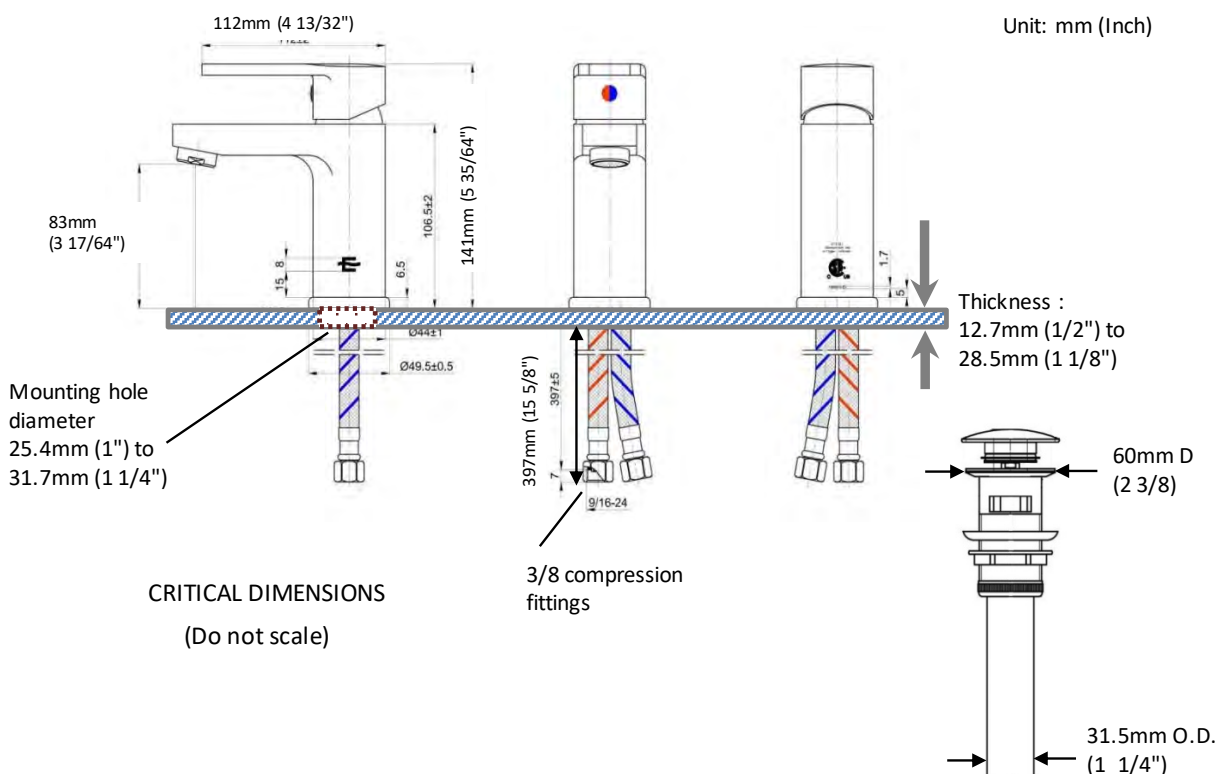

Model No. (Coating, Suffix No.)

KXH3251-CR-C

KXH3251-BN-C

KXH3251-BLK -C

KXH3251-PB-C

KXH3251-BB-C



Description

- 3/8 Compression fittings
- Strong metal construction with excellent outer coating
- Five different color coatings available identified by alphabets such as CR=Chrome, BN=Brushed Nickel, BLK=Black, PB=Polished Brass, BB=Brushed Brass
- Includes a Click Waste identified by suffix -C
- Available an Escutcheon (4") additionally for three-hole wash basin

Single-Handle Lavatory Faucet

Operation

- Easy control of between hot and cold water and Open Close operation by one lever handle

Water Flow Rate

- Maximum Flow Rate is 1.2gpm (4.5L/min) at 60psi

Cartridge

- Contain durable ceramic disc for smooth and comfortable operation

Standards

- Third party certified to ASME A112.18.1/CSA B125.1, NSF 61 (Q_s≤1), NSF372, Water Sense and CEC
- California Proposition 65 Include lead (Pb) in the waste drain. For more information go to www.P65Warnings.ca.gov

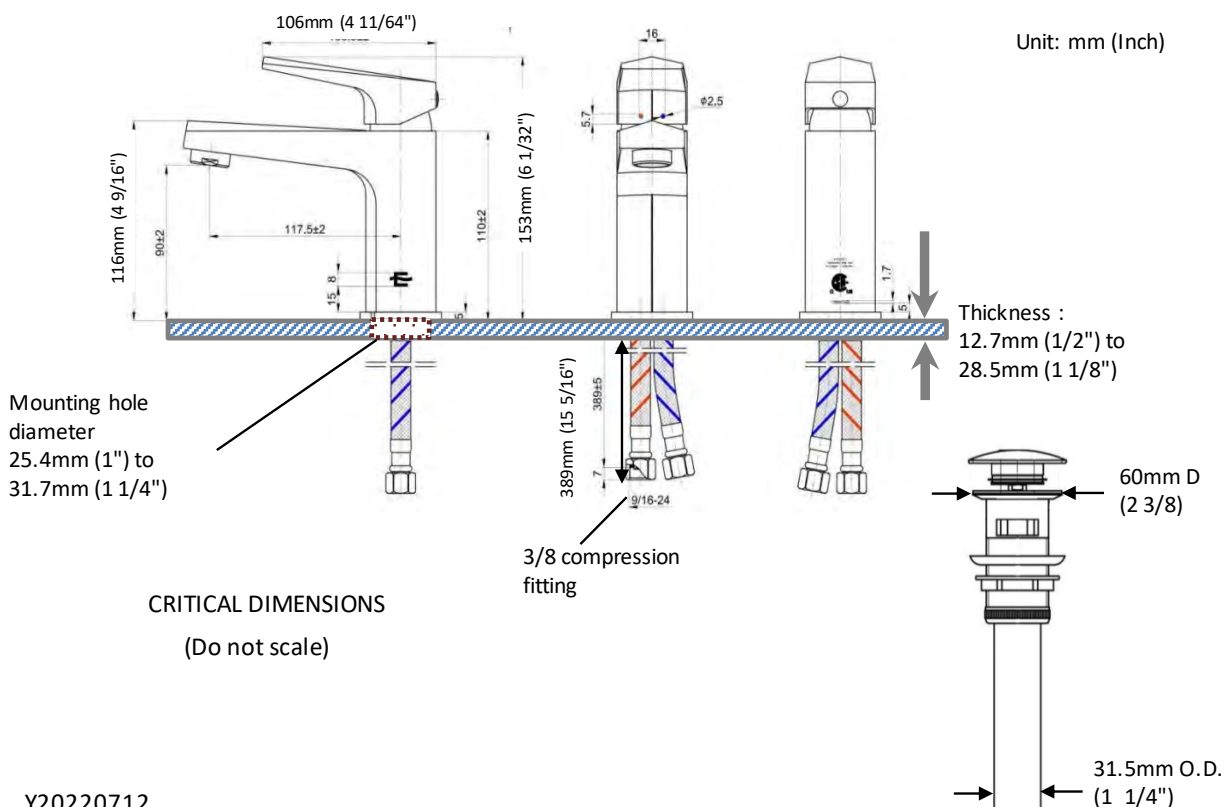

Model No. (Coating, Suffix No.)

KXH3257-CR-C

KXH3257-BN-C

KXH3257-BLK -C

KXH3257-PB-C

KXH3257-BB-C



Description

- 3/8 Compression fittings
- Strong metal construction with excellent outer coating
- Five different color coatings available identified by alphabets such as CR=Chrome, BN=Brushed Nickel, BLK=Black, PB=Polished Brass, BB=Brushed Brass
- Includes a Click Waste identified by suffix -C.
- Available an Escutcheon (4") additionally for three-hole wash basin.

Single-Handle Lavatory Faucet

Operation

- Easy control of between hot and cold water and Open Close operation by one lever handle

Water Flow Rate

- Maximum Flow Rate is 1.2gpm (4.5L/min) at 60psi

Cartridge

- Contain durable ceramic disc for smooth and comfortable operation

Standards

- Third party certified to ASME A112.18.1/CSA B125.1, NSF 61 (Q≤1), NSF372, Water Sense and CEC
- California Proposition 65 Include lead (Pb) in the waste drain. For more information go to www.P65Warnings.ca.gov

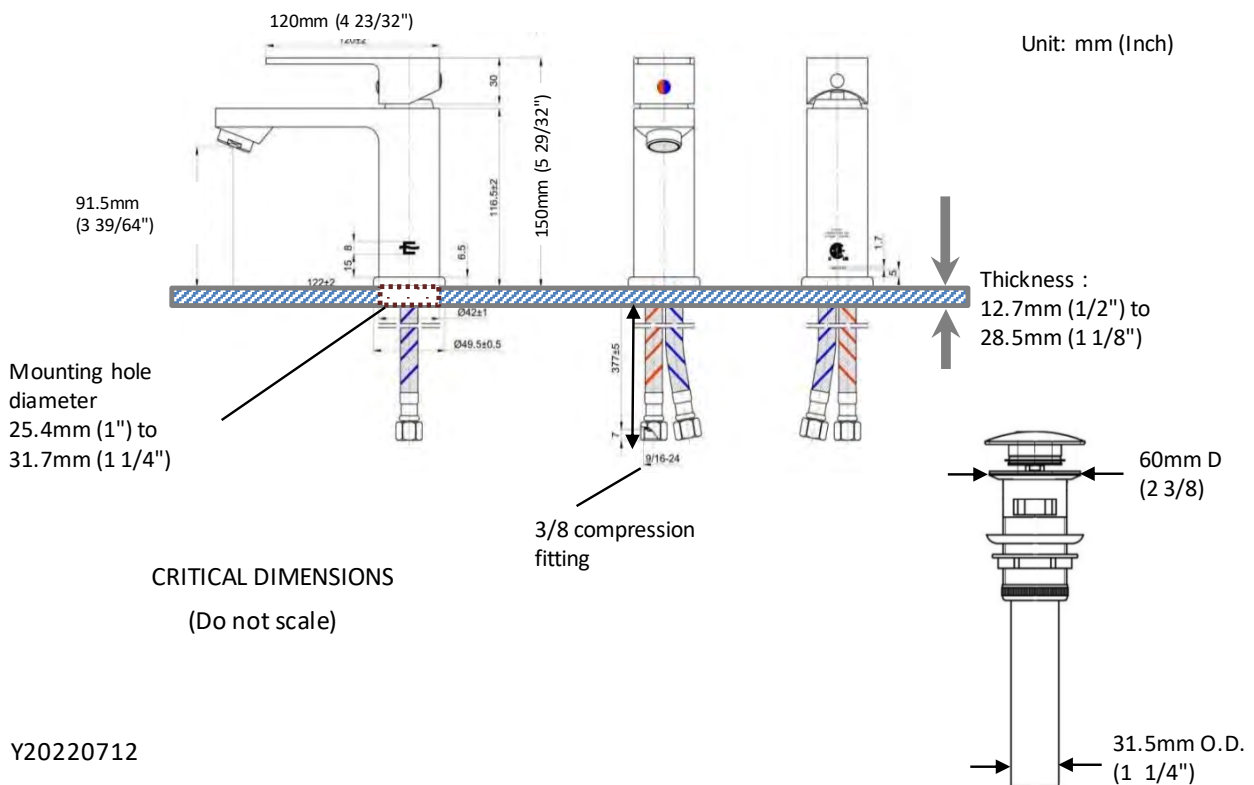

Model No. (Coating, Suffix No.)

KXH3281-CRH-C

KXH3281-BNH-C

KXH3281-BLKH-C

KXH3281-PBH-C

KXH3281-BBH-C



Single-Handle Lavatory Faucet

Description

- 3/8 Compression fittings
- Strong metal construction with excellent outer coating
- Five different color coatings available identified by alphabets such as CR=Chrome, BN=Brushed Nickel, BLK=Black, PB=Polished Brass, BB=Brushed Brass
- Includes a Click Waste identified by suffix -C
- Available an Escutcheon (4") additionally for three-hole wash basin

Operation

- Easy control of between hot and cold water and Open Close operation by one lever handle

Water Flow Rate

- Maximum Flow Rate is 1.2gpm (4.5L/min) at 60psi

Cartridge

- Contain durable ceramic disc for smooth and comfortable operation

Standards

- Third party certified to ASME A112.18.1/CSA B125.1, NSF 61 (Q≤1), NSF372, Water Sense and CEC
- California Proposition 65 Include lead (Pb) in the waste drain. For more information go to www.P65Warnings.ca.gov

